

**Front Access SLA Battery**

**FA Series**

FA (Front access) Series batteries are designed to be used in the area of communication, which features on new technology in design, reasonable in structure and occupying the leading position in the same industry of the world. The estimated life of FA Series batteries under float service is up to 15 years. It can be employed in numerous application in the fields of telecommunications.

**Application**

- Telecom
- Control Equipment
- UPS
- Communication Equipment
- Medical Equipment
- Emergency Power System

**General Features**

- Easy maintenance and installation
- No need for extra (wrench space) above battery
- Sealed and maintenance free operation
- Non-Spillable construction design
- ABS containers and covers(UL94HB, UL94V-0) optional
- Safety valve installation for explosion proof
- Maximized energy density for installation in relay rack trays
- High quality and high reliability
- Exceptional deep discharge recovery performance
- Flexibility design for multiple install positions

**Construction**

- Component .....Raw material
- Positive .....Lead dioxide
- Negative .....Lead
- Container .....ABS
- Cover .....ABS
- Sealant .....Epoxy Resin
- Safety valve .....EPDR
- Terminal .....Copper
- Separator .....Fiber glass
- Electrolyte .....Sulfuric acid

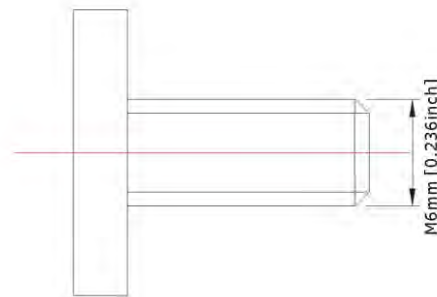

**Terminal Dimensions**

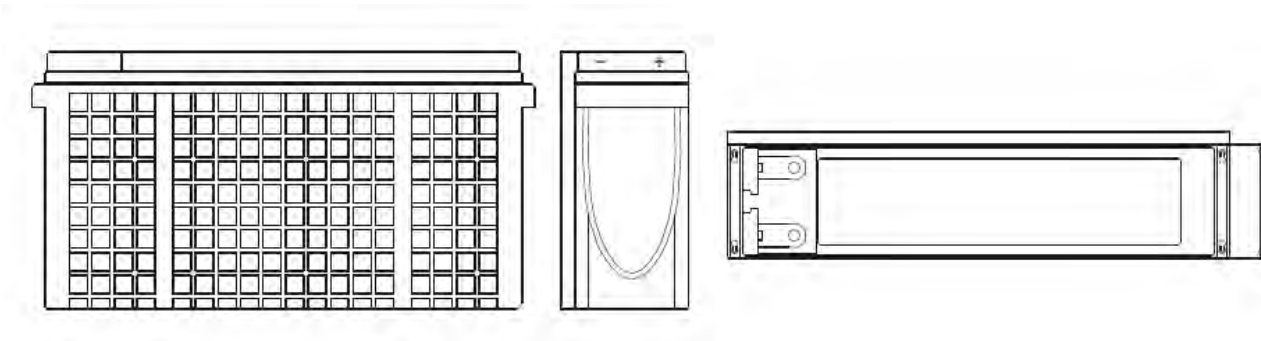

|                                  |   |                   |                       |                  |
|----------------------------------|---|-------------------|-----------------------|------------------|
| Battery Model                    | FA12-155                                    |                   |                       |                  |
| Designed Floating Life           | 12 Years                                    |                   |                       |                  |
| Capacity(25°C)                   | 20HR(7.8A,1.75V)                            | 10HR(15.5A,1.75V) | 5HR(27.8A,1.75V)      | 1HR(88A,1.75V)   |
|                                  | 156AH                                       | 155AH             | 139AH                 | 88AH             |
| Dimensions                       | Length                                      | Width             | Height                | Total Height     |
|                                  | 558mm(21.96inch)                            | 124mm(4.88inch)   | 283mm(11.14inch)      | 283mm(11.14inch) |
| Approx. Weight                   | 54Kg (119.07 lbs)                           |                   |                       |                  |
| Internal Resistance              | Full charged at 25°C: 0.00387 Ohm           |                   |                       |                  |
| Self Discharge                   | 3% of capacity declined per month at (25°C) |                   |                       |                  |
| Capacity Affected by Temp.(20HR) | 40°C  | 25°C              | 0°C                   | -15°C            |
|                                  | 105%  | 100%              | 85%                   | 68%              |
| Charge Voltage(25°C)             | Cycle use                                   |                   | Float use             |                  |
|                                  | 14.4-15V(-30mV/ °C), max. Current: 37.5A    |                   | 13.6-13.8V(-20mV/ °C) |                  |

Front Access SLA Battery

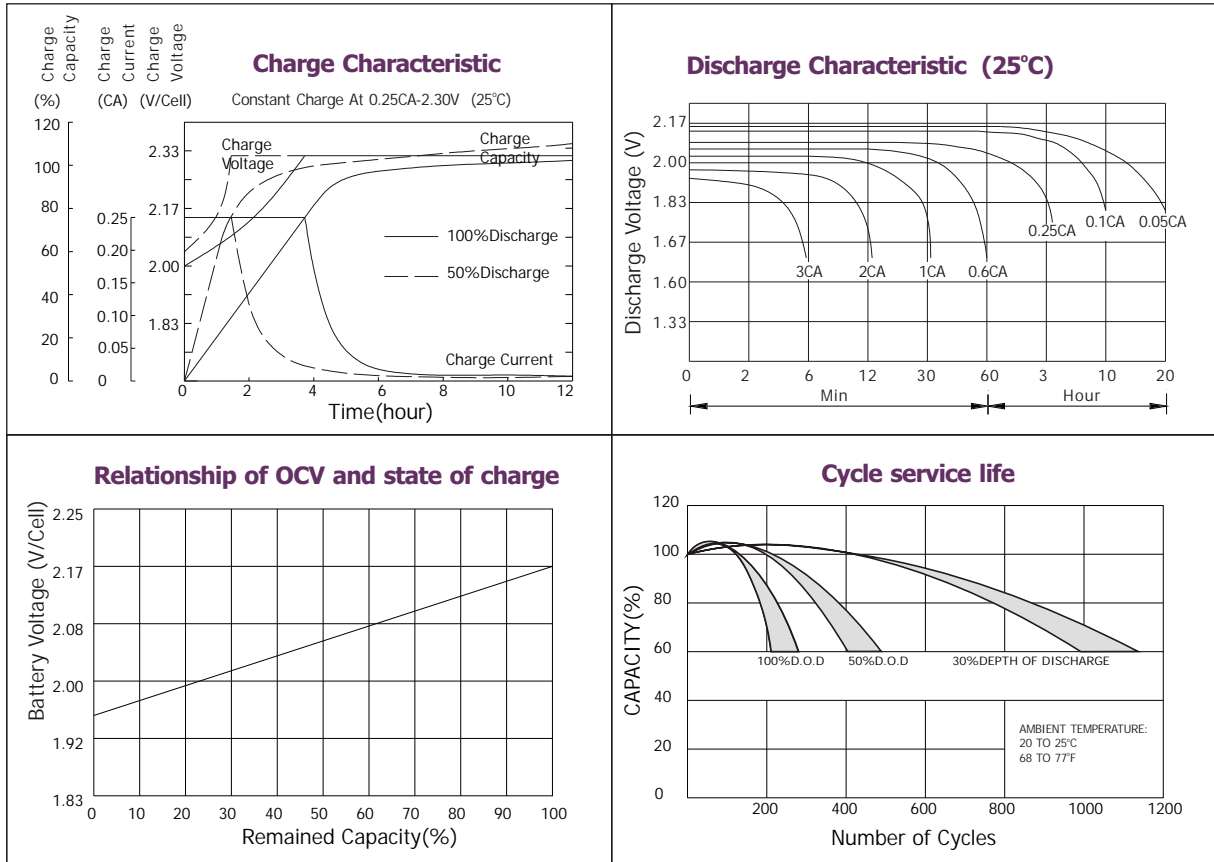

**Constant current discharge ratings-amperes at 25°C**

| F. V/Time | 5MIN | 10MIN | 15MIN | 30MIN | 1HR  | 3HR  | 5HR  | 10HR | 20HR |
|-----------|------|-------|-------|-------|------|------|------|------|------|
| 1.60V     | 543  | 372   | 271   | 163   | 102  | 42.3 | 29.6 | 16.4 | 8.17 |
| 1.67V     | 488  | 339   | 264   | 158   | 102  | 42.2 | 29.3 | 16.2 | 8.14 |
| 1.70V     | 463  | 327   | 254   | 155   | 102  | 42.2 | 29.3 | 16.1 | 8.14 |
| 1.75V     | 412  | 302   | 240   | 152   | 101  | 41.9 | 29.1 | 15.8 | 8.10 |
| 1.80V     | 372  | 281   | 229   | 147   | 99.5 | 41.7 | 28.9 | 15.5 | 7.82 |
| 1.85V     | 282  | 231   | 198   | 135   | 98.4 | 41.5 | 28.6 | 15.2 | 7.35 |

**Constant power discharge ratings-watts at 25°C**

| F. V/Time | 5MIN | 10MIN | 15MIN | 30MIN | 1HR | 3HR  | 5HR  | 10HR | 20HR |
|-----------|------|-------|-------|-------|-----|------|------|------|------|
| 1.60V     | 894  | 617   | 481   | 307   | 202 | 81.2 | 56.6 | 32.9 | 16.3 |
| 1.67V     | 848  | 609   | 476   | 301   | 195 | 81.2 | 56.6 | 32.4 | 16.3 |
| 1.70V     | 792  | 594   | 468   | 293   | 190 | 81.2 | 56.6 | 32.1 | 16.3 |
| 1.75V     | 738  | 555   | 440   | 285   | 188 | 80.0 | 56.0 | 31.6 | 16.2 |
| 1.80V     | 662  | 516   | 414   | 277   | 185 | 78.9 | 55.0 | 31.0 | 15.6 |
| 1.85V     | 530  | 428   | 361   | 254   | 183 | 78.6 | 54.3 | 30.5 | 14.7 |

