

Front Access SLA Battery

FA Series

FA (Front access) Series batteries are designed to be used in the area of communication, which features on new technology in design, reasonable in structure and occupying the leading position in the same industry of the world. The estimated life of FA Series batteries under float service is up to 15 years. It can be employed in numerous application in the fields of telecommunications.

Application

- Telecom
- Control Equipment
- UPS
- Communication Equipment
- Medical Equipment
- Emergency Power System

General Features

- Easy maintenance and installation
- No need for extra (wrench space) above battery
- Sealed and maintenance free operation
- Non-Spillable construction design
- ABS containers and covers(UL94HB, UL94V-0) optional
- Safety valve installation for explosion proof
- Maximized energy density for installation in relay rack trays
- High quality and high reliability
- Exceptional deep discharge recovery performance
- Flexibility design for multiple install positions

Construction

- ComponentRaw material
- PositiveLead dioxide
- NegativeLead
- ContainerABS
- CoverABS
- SealantEpoxy Resin
- Safety valveEPDR
- TerminalCopper
- SeparatorFiber glass
- ElectrolyteSulfuric acid

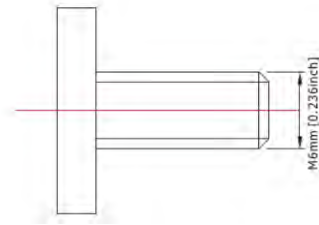

Terminal Dimensions

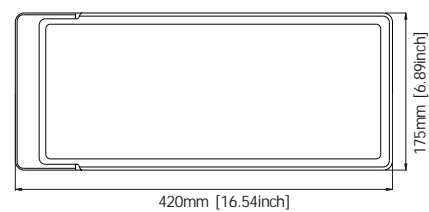
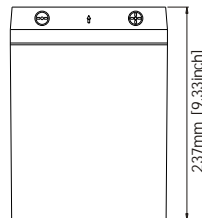
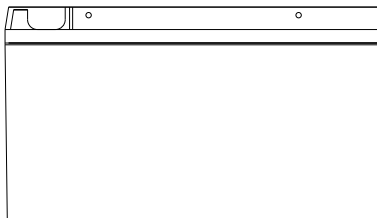

Battery Model	FA12-125			
Designed Floating Life	12 Years			
Capacity(25°C)	20HR(6.35A,1.75V)	10HR(12.5A,1.75V)	5HR(21.4A,1.75V)	1HR(81A,1.75V)
	127AH	125AH	107AH	81AH
Dimensions	Length	Width	Height	Total Height
	420mm(16.54inch)	175mm(6.89inch)	237mm(9.33inch)	237mm(9.33inch)
Approx. Weight	44.5Kg (98.12 lbs)			
Internal Resistance	Full charged at 25°C: 0.004 Ohm			
Self Discharge	3% of capacity declined per month at (25°C)			
Capacity Affected by Temp.(20HR)	40°C	25°C	0°C	-15°C
	102%	100%	85%	65%
Charge Voltage(25°C)	Cycle use		Float use	
	14.4-15V(-30mV/ °C), max. Current: 31.3A		13.6-13.8V(-20mV/ °C)	

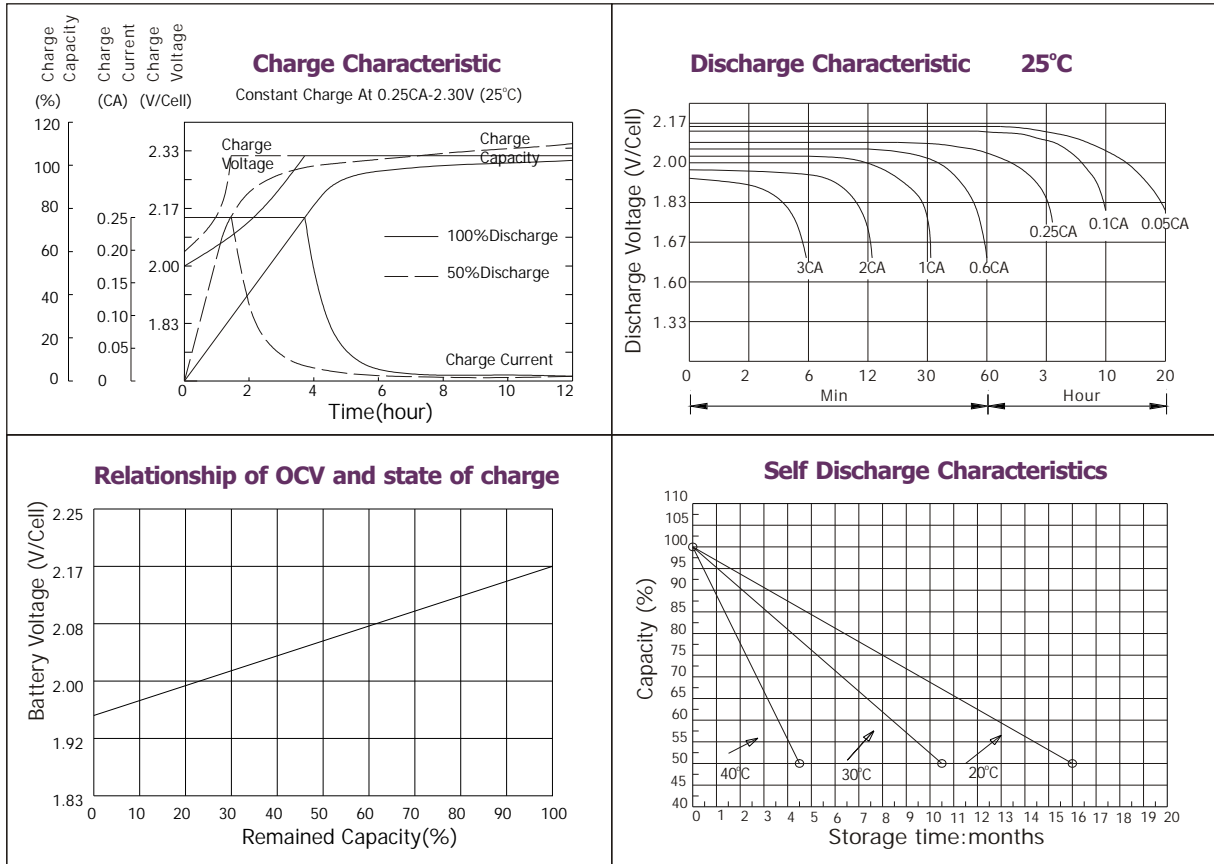

Constant current discharge ratings-amperes at 25°C

F.V/Time	1MIN	5MIN	10MIN	15MIN	30MIN	1HR	3HR	4HR	5HR	10HR	20HR
1.60V	624	445	305	222	133	83.8	34.7	28.1	24.2	13.5	6.96
1.67V	562	400	278	216	130	83.7	34.5	28.0	24.0	13.3	6.93
1.70V	533	380	268	208	127	83.4	34.5	28.0	24.0	13.2	6.93
1.75V	474	338	248	197	124	82.6	34.3	27.8	23.8	12.9	6.90
1.80V	428	305	230	188	121	81.5	34.2	27.6	23.6	12.7	6.66
1.85V	325	231	189	163	111	80.6	34.0	27.4	23.4	12.5	6.26

Constant power discharge ratings-watts at 25°C

F.V/Time	1MIN	5MIN	10MIN	15MIN	30MIN	1HR	3HR	4HR	5HR	10HR	20HR
1.60V	1029	733	505	394	251	165	66.5	53.9	46.4	26.9	13.9
1.67V	976	695	499	390	246	160	66.5	53.9	46.4	26.5	13.9
1.70V	911	649	486	384	240	155	66.5	53.9	46.4	26.3	13.9
1.75V	849	605	455	361	234	154	65.5	53.2	45.8	25.9	13.8
1.80V	762	542	423	339	227	151	64.6	52.4	45.1	25.4	13.3
1.85V	610	434	351	296	208	150	64.4	51.9	44.5	25.0	12.5

