

Electric Vehicle SLA Battery

EVX SERIES

Bosfa EVX Series batteries are designed to have a large amount of stored current discharged between charging sessions, with very heavy non-porous battery plates to withstand repeated major discharging and charging cycle (deep cycles). The Bosfa EVX batteries uses a different chemistry for the plates active paste material, and a slightly stronger electrolyte than normal battery electrolyte, which allows for a much longer life in deep cycle applications.

Application

- Electric Powered Vehicles
- Golf Cars and Buggies
- Wheel Chairs
- Power Tools
- Electric Powered Toys
- Control System
- Vacuum Cleaners
- Medical Equipments
- UPS
- Pvs

General Features

- Sealed and maintenance free operation.
- Non-Spillable construction design.
- ABS containers and covers(UL94HB, UL94V-0) optional.
- Safety valve installation for explosion proof.
- High quality and high reliability.
- Exceptional deep discharge recovery performance.
- Low self discharge characteristic.
- Flexibility design for multiple install positions.

Construction

- ComponentRaw material
- PositiveLead dioxide
- NegativeLead
- ContainerABS
- CoverABS
- SealantEpoxy Resin
- Safety valveEPDR
- TerminalCopper
- SeparatorFibre glass
- ElectrolyteSulfuric acid

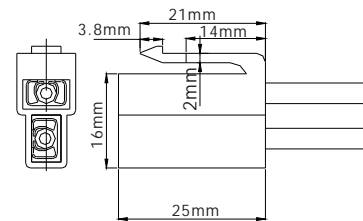

Terminal Dimensions

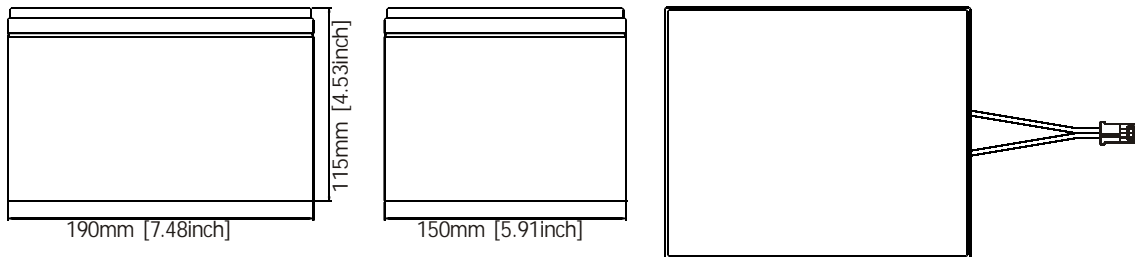

| | | | | |
|----------------------------------|---|------------------|------------------|-----------------|
| Battery Model | EVX24-16 | | | |
| Designed Cycle Life | > 350 cycles @ 100% DOD | | | |
| Capacity(25°C) | 20HR(0.8A,1.75V) | 10HR(1.5A,1.75V) | 2HR(7A,1.75V) | 1HR(9.6A,1.75V) |
| | 16AH | 15AH | 14AH | 9.6AH |
| Dimensions | Length | Width | Height | Total Height |
| | 190mm(7.48inch) | 150mm(5.91inch) | 115mm(4.53inch) | 115mm(4.53inch) |
| Approx. Weight | 9.4 Kg (20.73 lbs) | | | |
| Internal Resistance | Full charged at 25°C: 0.03 Ohm | | | |
| Self Discharge | 3% of capacity declined per month at (25°C) | | | |
| Capacity Affected by Temp.(20HR) | 40°C | 25°C | 0°C | -15°C |
| | 102% | 100% | 85% | 65% |
| Charge Voltage(25°C) | Cycle use | | Float use | |
| | 27.1V(-55mV/ °C), max. Current: 4.5A | | 25.3V(-35mV/ °C) | |

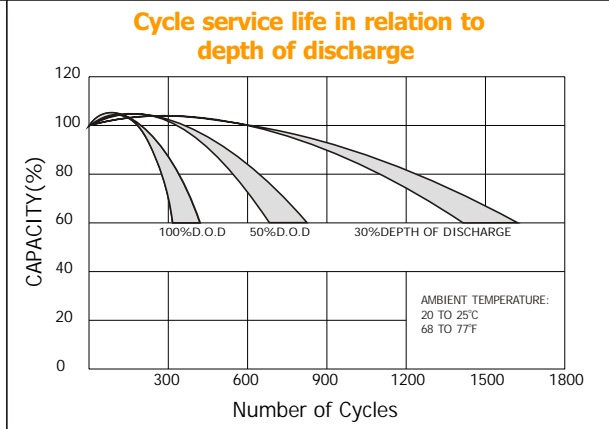
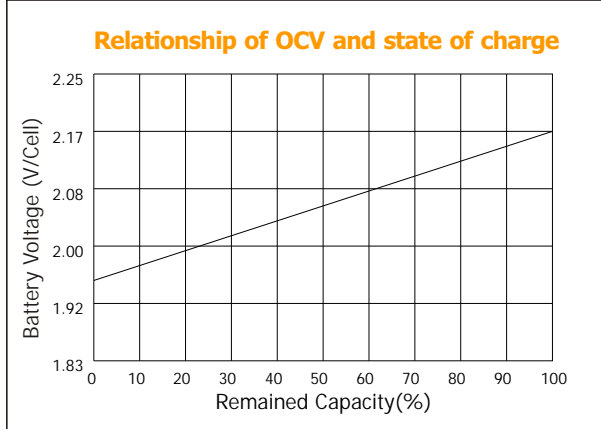
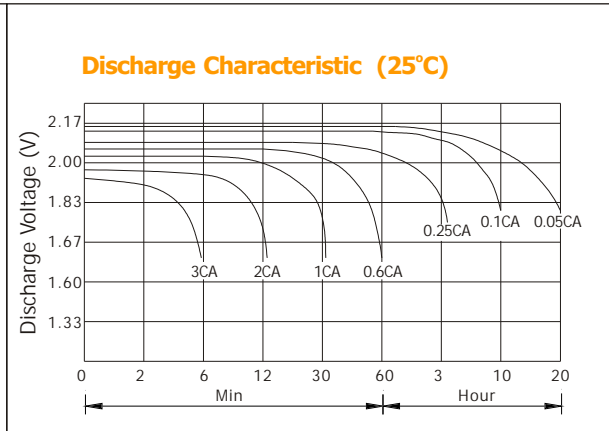
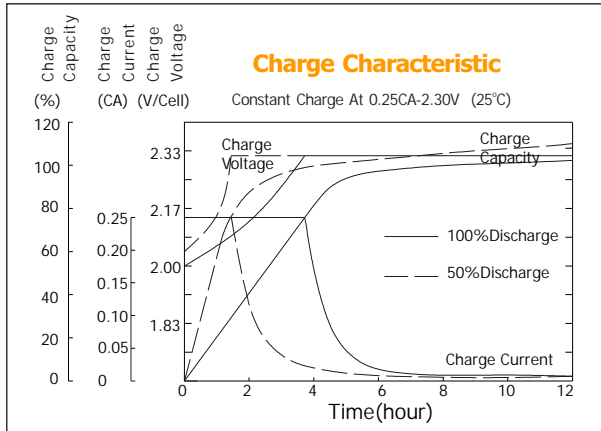

Constant current discharge ratings-amperes at 25°C

| F. V/Time | 5MIN | 10MIN | 15MIN | 30MIN | 1HR | 3HR | 5HR | 10HR | 20HR |
|-----------|------|-------|-------|-------|------|------|------|------|------|
| 1.60V | 62.5 | 38.9 | 29.3 | 17.9 | 11.4 | 4.99 | 3.05 | 1.71 | 0.90 |
| 1.67V | 58.7 | 36.9 | 28.2 | 17.1 | 11.2 | 4.80 | 2.99 | 1.69 | 0.87 |
| 1.70V | 53.8 | 35.6 | 27.6 | 15.6 | 10.9 | 4.48 | 2.92 | 1.68 | 0.85 |
| 1.75V | 52.7 | 34.4 | 26.7 | 14.8 | 10.4 | 4.33 | 2.86 | 1.66 | 0.83 |
| 1.80V | 47.1 | 32.9 | 24.2 | 13.7 | 9.71 | 4.16 | 2.69 | 1.64 | 0.81 |
| 1.85V | 41.6 | 31.3 | 21.8 | 12.6 | 9.05 | 4.01 | 2.52 | 1.62 | 0.79 |

Constant power discharge ratings-watts at 25°C

| F. V/Time | 5MIN | 10MIN | 15MIN | 30MIN | 1HR | 3HR | 5HR | 10HR | 20HR |
|-----------|------|-------|-------|-------|------|------|------|------|------|
| 1.60V | 110 | 70.2 | 53.6 | 32.2 | 20.5 | 8.85 | 5.16 | 3.41 | 1.79 |
| 1.67V | 106 | 68.4 | 52.9 | 31.6 | 20.4 | 8.58 | 5.13 | 3.39 | 1.73 |
| 1.70V | 99.6 | 67.8 | 52.4 | 29.6 | 20.0 | 8.19 | 5.07 | 3.37 | 1.71 |
| 1.75V | 94.0 | 67.6 | 52.0 | 28.7 | 19.7 | 8.00 | 5.02 | 3.33 | 1.66 |
| 1.80V | 91.7 | 66.6 | 48.2 | 27.3 | 18.5 | 7.77 | 4.87 | 3.29 | 1.62 |
| 1.85V | 83.2 | 63.1 | 43.7 | 25.6 | 17.4 | 7.53 | 4.71 | 3.24 | 1.56 |

