

Deep Cycle SLA Battery

Range Summary

By combining up-to-date DCP additives in the positive plates and special AGM separators, bosfa created an innovative range of DC batteries. The range features 70% higher cyclic life with 12 years of float life when compared with standard Duration range. The battery series is highly suited to very unreliable power applications requiring the batteries to provide extra cyclic life performance such as outdoor applications, small RE systems and electric vehicles.

Application

- Solar Energy System
- Golf Cars and Buggies
- Electric Powered Vehicles
- Wheel Chairs
- Power Tools
- Electric Powered Toys
- Control System
- Vacuum Cleaners
- Medical Equipments
- UPS

General Features

- Sealed and maintenance free operation.
- Non-Spillable construction design.
- ABS containers and covers(UL94 V0,optional).
- Safety valve installation for explosion proof.
- High quality and high reliability.
- Exceptional deep discharge recovery performance.
- Low self discharge characteristic.
- Flexible design for multiple installation positions.

Construction

- Positive .....Lead dioxide
- Negative .....Lead
- Container .....ABS
- Cover .....ABS
- Sealant .....Epoxy Resin
- Safety valve ....EPDR
- Terminal .....Copper
- Separator .....AGM
- Electrolyte .....Sulfuric acid

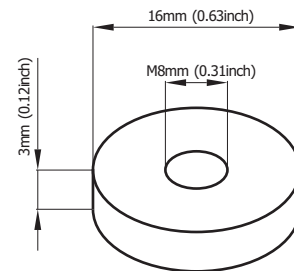

Terminal Dimensions

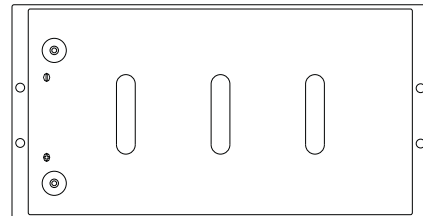
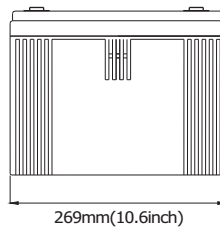
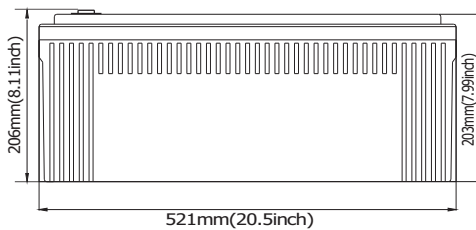

Battery Model	DC 12-230			
Designed Cycle Life	> 350 cycles @ -0.5CA to 9.6V			
Capacity(20°C)	20HR(12.2A,1.80V)	10HR(23A,1.80V)	5HR(39.3A,1.75V)	1HR(144A,1.60V)
	244AH	230AH	197AH	144AH
Dimensions	Length	Width	Height	Total Height
	521mm(20.5inch)	269mm(10.6inch)	203mm(7.99inch)	206mm(8.11inch)
Approx. Weight	60Kg (132.58 lbs)			
Internal Resistance	Full charged at 20°C: 0.0028 Ohm			
Self Discharge	3% of capacity declined per month at (20°C)			
Capacity Affected by Temp.(20HR)	40°C	20°C	0°C	-15°C
	102%	100%	85%	65%
Charge Voltage(20°C)	Cycle use		Float use	
	14.4-14.8V(-30mV/ °C), max. Current: 57.5A		13.6-13.8V(-20mV/ °C)	

Deep Cycle SLA Battery

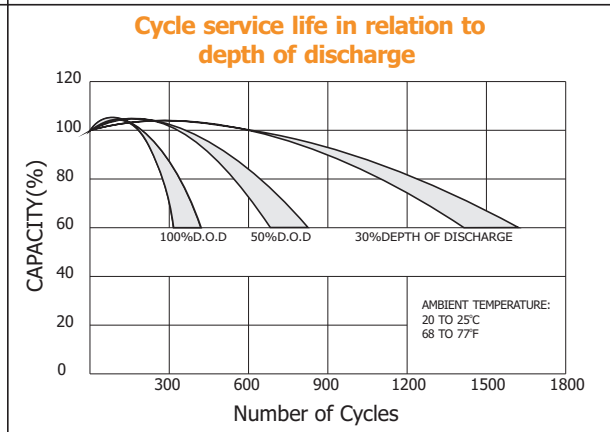
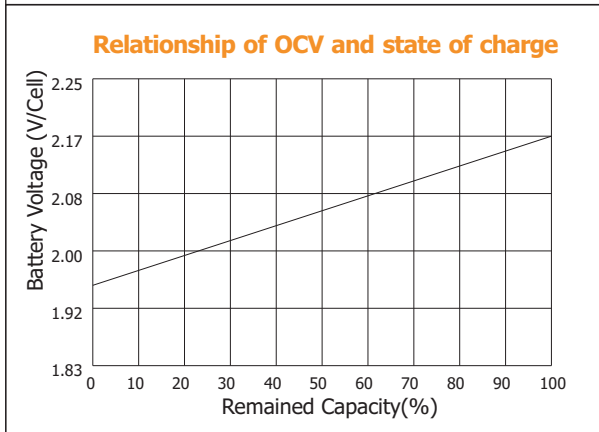
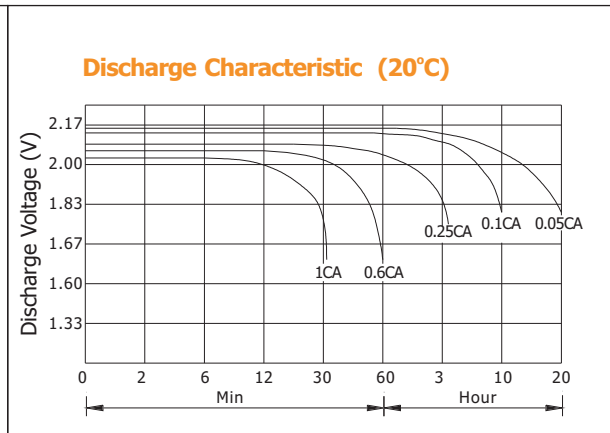
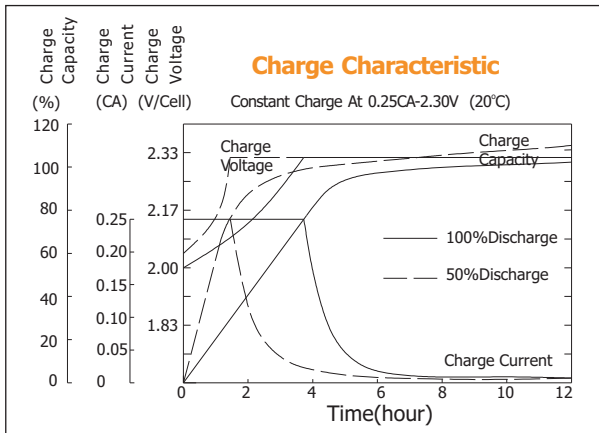

Constant current discharge ratings-amperes at 20°C

F. V/Time	5MIN	10MIN	15MIN	30MIN	1HR	3HR	5HR	10HR	20HR
1.60V	805	552	403	242	144	62.8	39.9	24.4	12.7
1.67V	725	504	391	235	144	62.6	39.6	24.0	12.7
1.70V	688	485	377	230	144	62.6	39.6	23.8	12.7
1.75V	612	449	357	225	142	62.1	39.3	23.4	12.6
1.80V	552	416	340	219	140	61.9	39.0	23.0	12.2
1.85V	419	343	294	201	139	61.6	38.6	22.6	11.4

Constant power discharge ratings-watts at 20°C

F. V/Time	5MIN	10MIN	15MIN	30MIN	1HR	3HR	5HR	10HR	20HR
1.60V	1327	915	713	455	299	121	84.0	48.8	24.2
1.67V	1258	904	706	446	289	121	84.0	48.0	24.2
1.70V	1175	881	695	435	282	121	84.0	47.7	24.2
1.75V	1095	823	653	423	279	119	83.0	46.9	24.0
1.80V	982	766	614	412	274	117	81.7	46.0	23.2
1.85V	787	635	536	377	272	117	80.5	45.2	21.8

